

Sending Destination via Bluetooth



To send the point selected by NaviCon to the car navigation system via Bluetooth, you need to set up pairing between your smartphone and the car navigation system.

Pairing determines the combination of connected devices (Pair). The following pages introduce specific procedures.

**The screen details and design may differ from the actual product.*



There is a type of Bluetooth connection called a "Profile" which requires pairing for each purpose.

Typical ones are for telephones (HFP) and for music playback (A2DP), but for NaviBridge to send a destination, you need to pair for data communication (SPP)

Some car navigation systems perform multiple pairing at the same time.

Connection



Once pairing is complete, the connection is automatically made the next time.

When NaviBridge is connected to the car navigation system, the indicator at the bottom right of the map screen changes to green "ONLINE".

**In some rare cases, pairing information may be lost depending on the usage situation. In this case, delete the entry from both your smartphone and car navigation and try pairing again.*

Smartphone

Car navigation

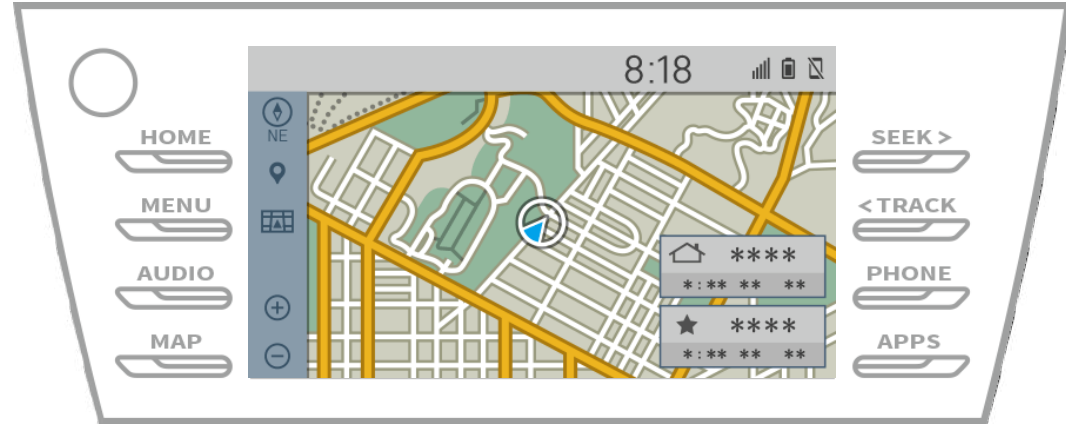
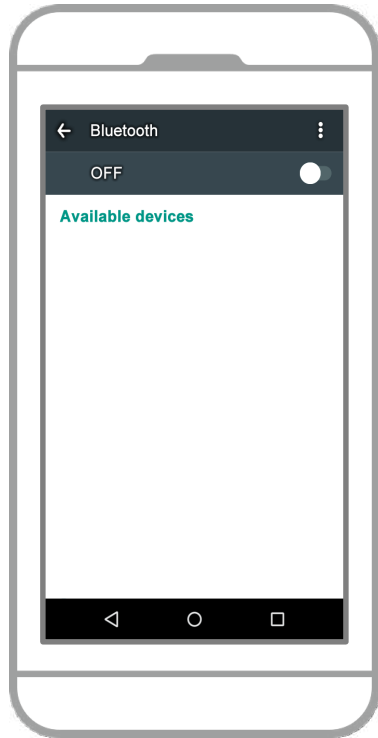

From the Android home screen, tap "Settings" → "Bluetooth" to display the Bluetooth settings screen.

Smartphone

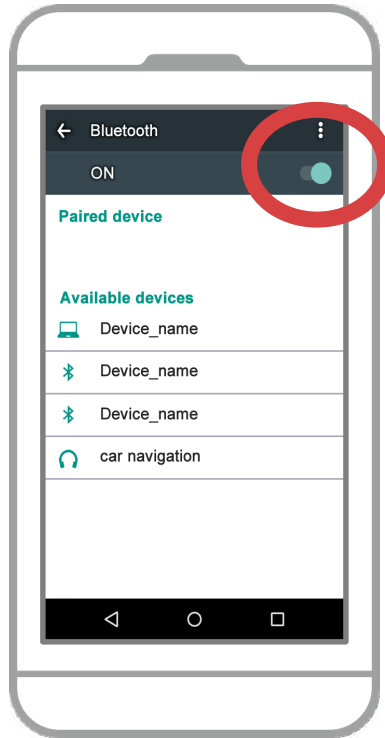

Car navigation

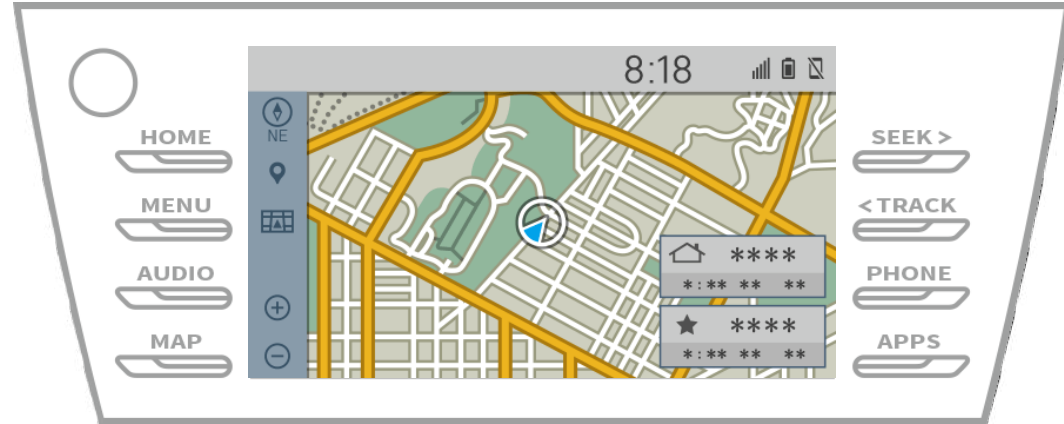



If Bluetooth is off, turn it on.

If the car navigation name is not displayed, select "Update" from the menu at the top right of the screen.

Smartphone

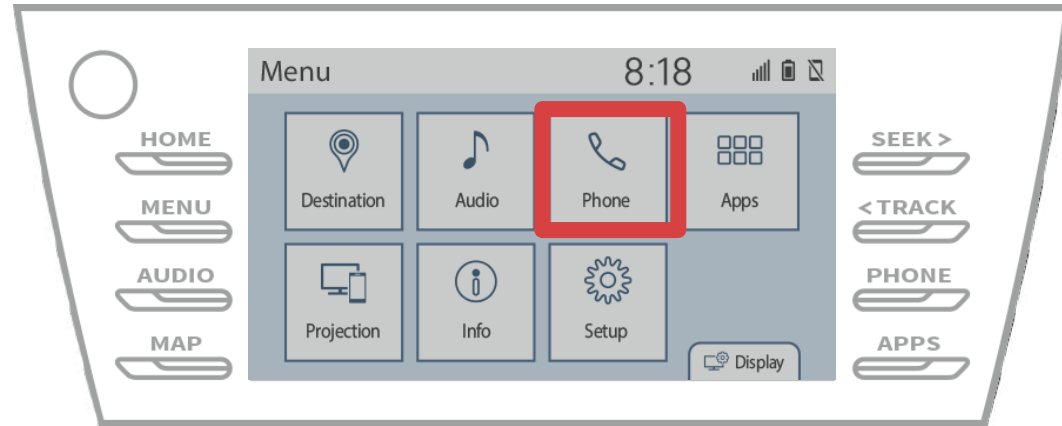
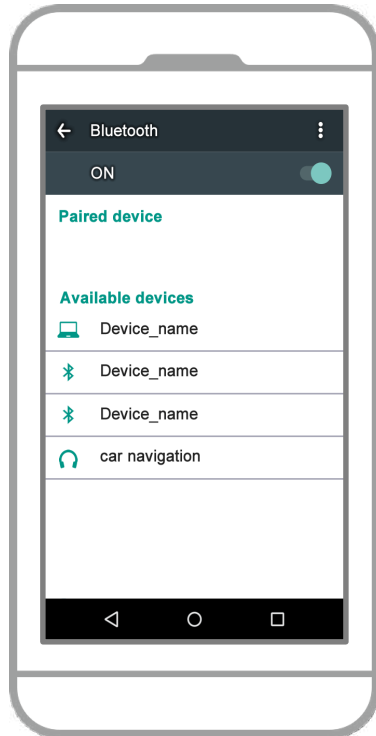
Car navigation



Select “  ” → “Settings” → “Phone”.

Smartphone

Car navigation

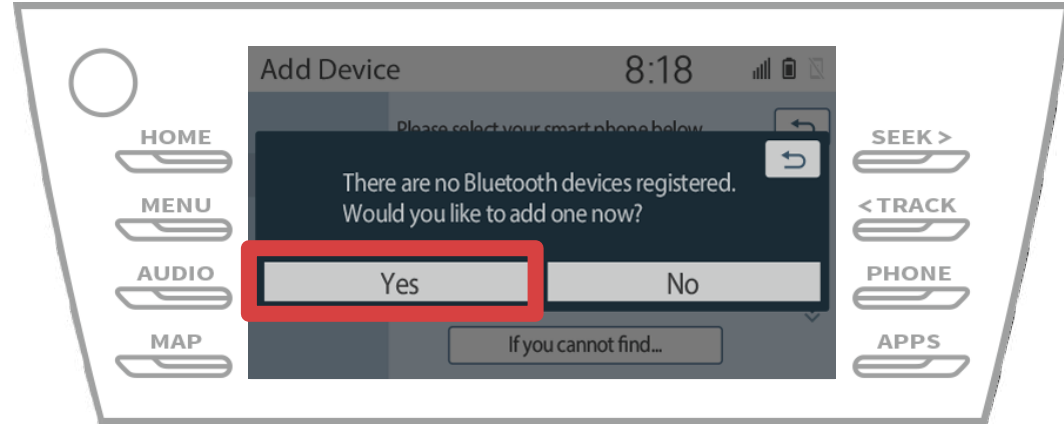
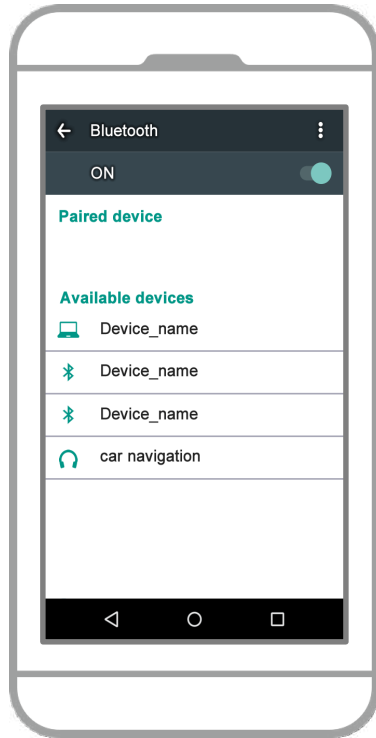

Select "Yes".

Smartphone

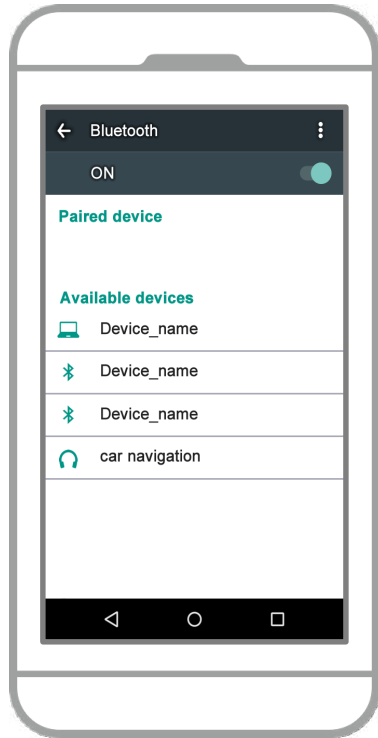

Car navigation

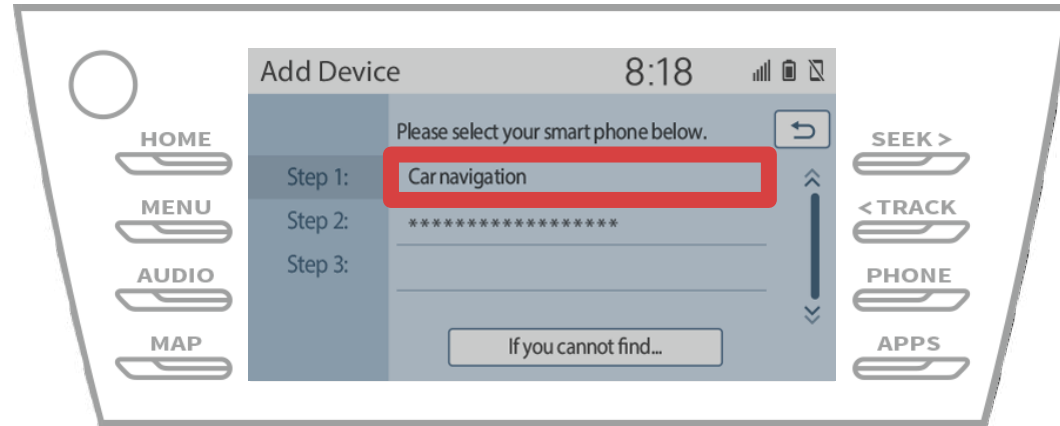

Select the desired Bluetooth device.

* If the desired Bluetooth phone is not on the list, select "If you cannot find..." and follow the guidance on the screen to register from the device.

Smartphone

Car navigation

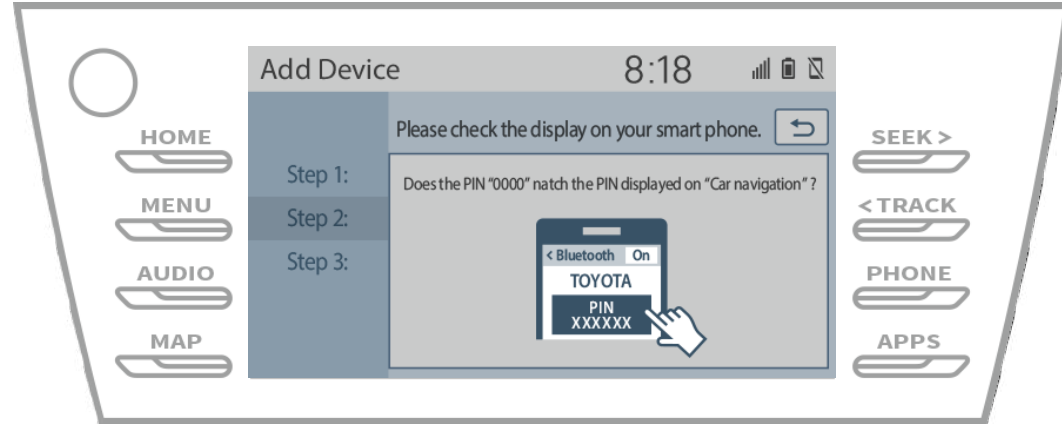
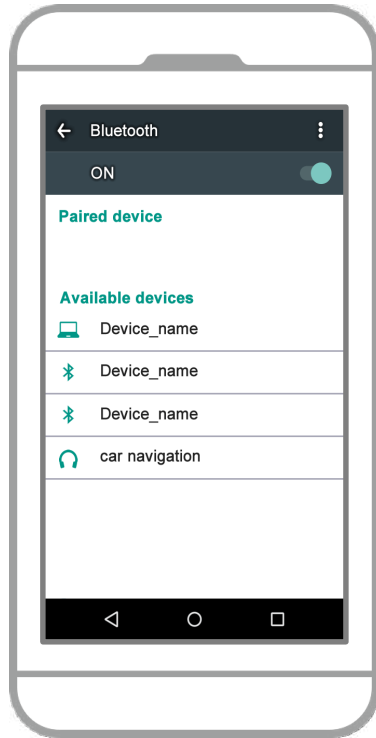

When this screen is displayed, register for Bluetooth from your smartphone.

Smartphone

Car navigation

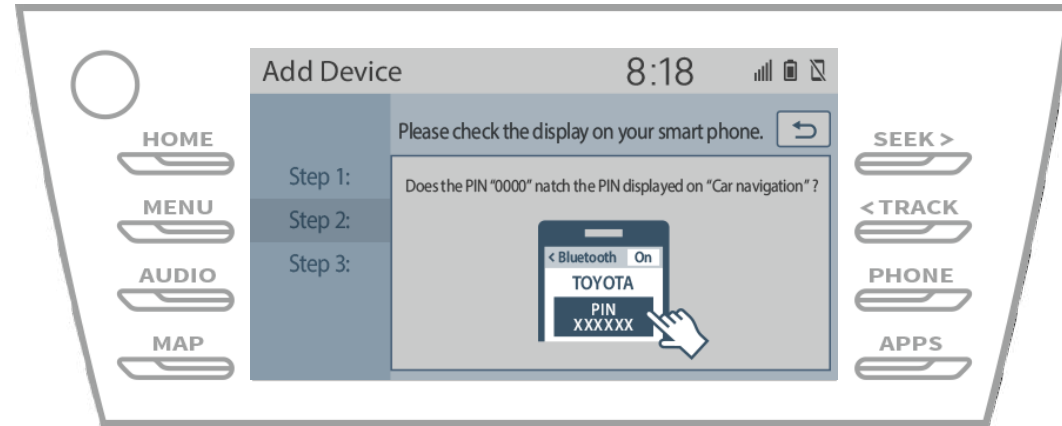
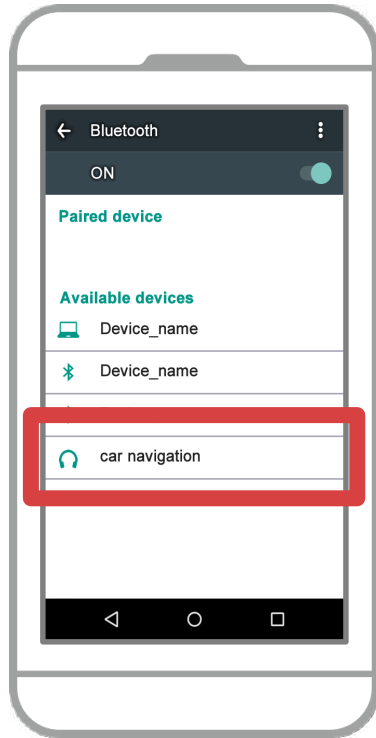

Select the device name (Car Navigation in this case).

* The device name differs depending on the car navigation system, so please check the instruction manual.

Smartphone

Car navigation

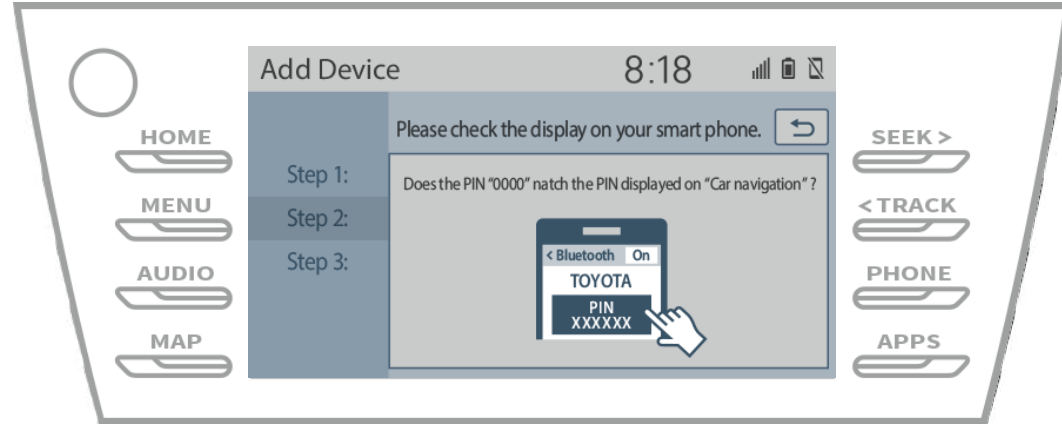
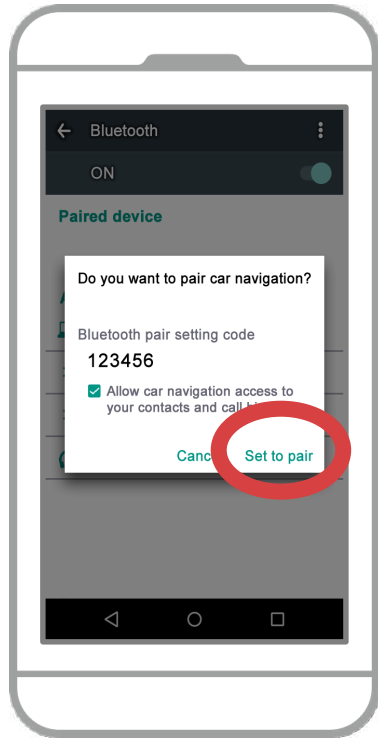

A Bluetooth pairing request will be displayed, so click "Pair".

Smartphone

Car navigation

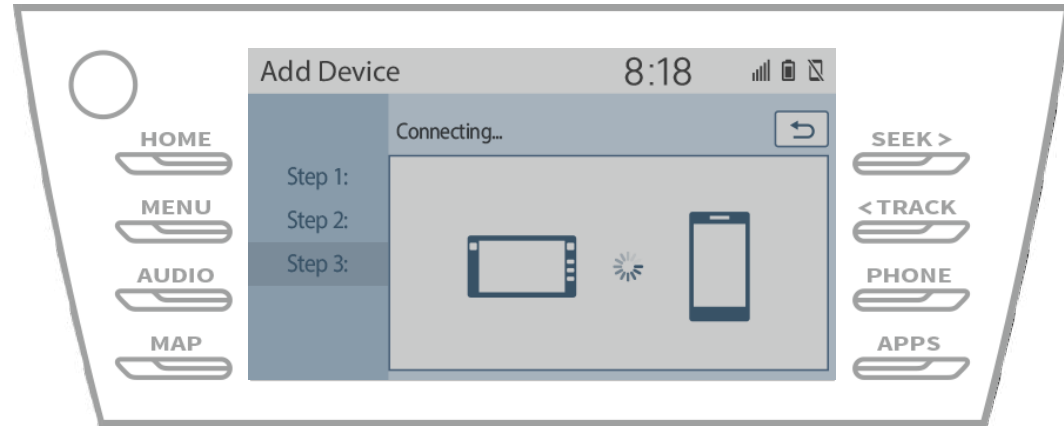
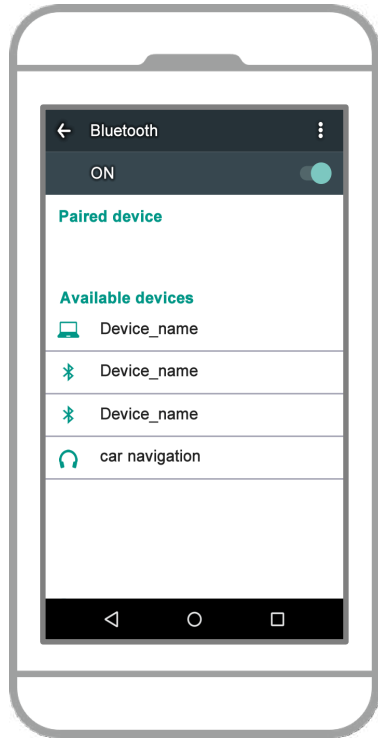

Check that the following screen is displayed, indicating pairing was successful (a Bluetooth link has been established but registration is not yet complete).

Smartphone

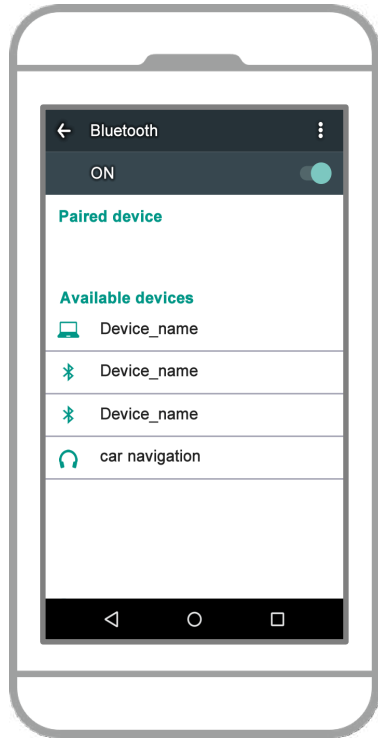

Car navigation

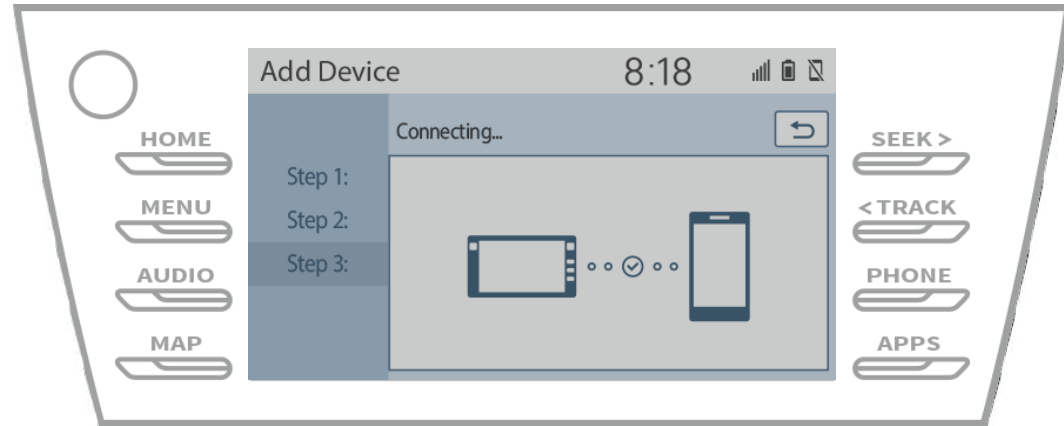

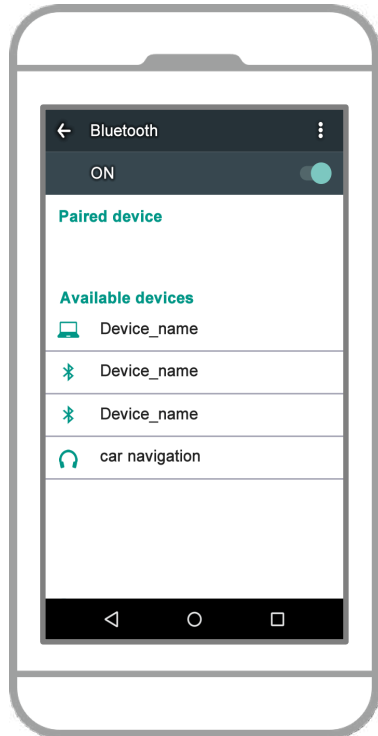

Check that “Connected” is displayed and registration is complete.
* If an error message is displayed, follow the guidance on the screen to try again.

Smartphone

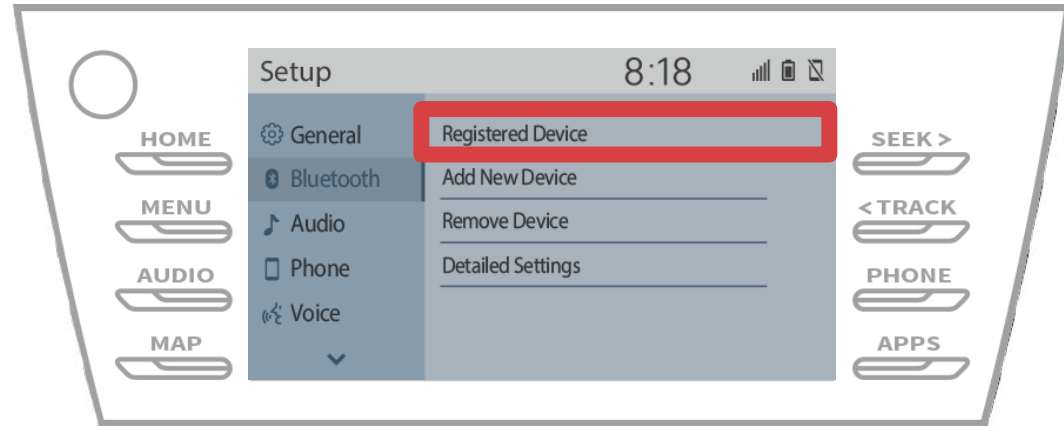

Car navigation



Next, set the profile of the car navigation device.
Touch "  " → "Set UP" → "Bluetooth" →
"Registered Device" on the car navigation screen.

Smartphone

Car navigation

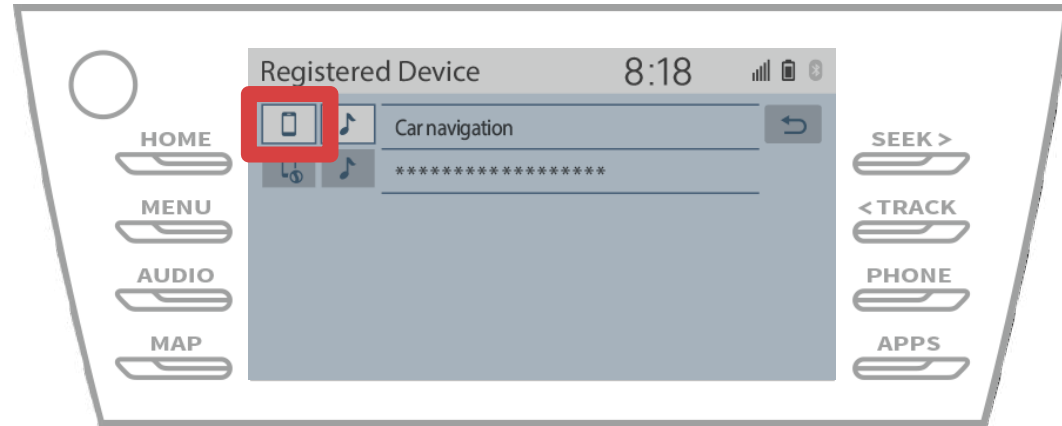
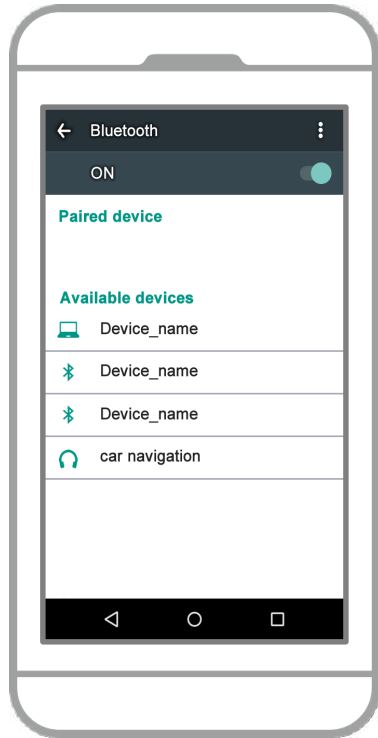

Touch the profile icon of the connected device.

When you select the profile icon, the connection to the function is switched, so set it to “ Phone / Toyota Entune App Suite Connect”.

Smartphone

Car navigation

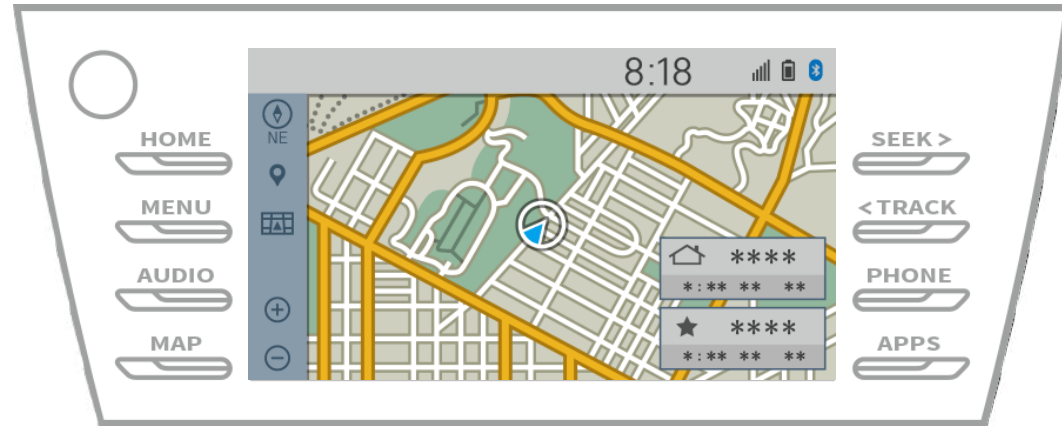
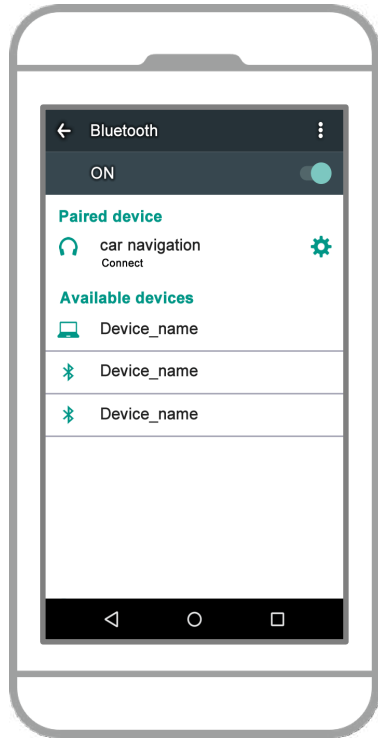

This completes the pairing of the smartphone and car navigation system.

After that, select the car navigation on NaviBridge.

Smartphone

Car navigation

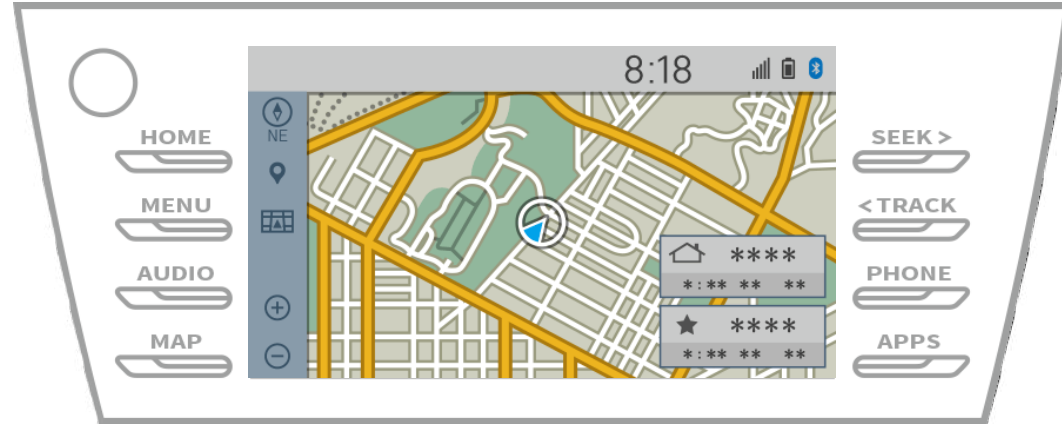

Start NaviBridge. The car navigation system you paired will be displayed. Select it and press "Done".

If this screen does not appear automatically when you start NaviBridge, follow the steps below.

Smartphone

Car navigation

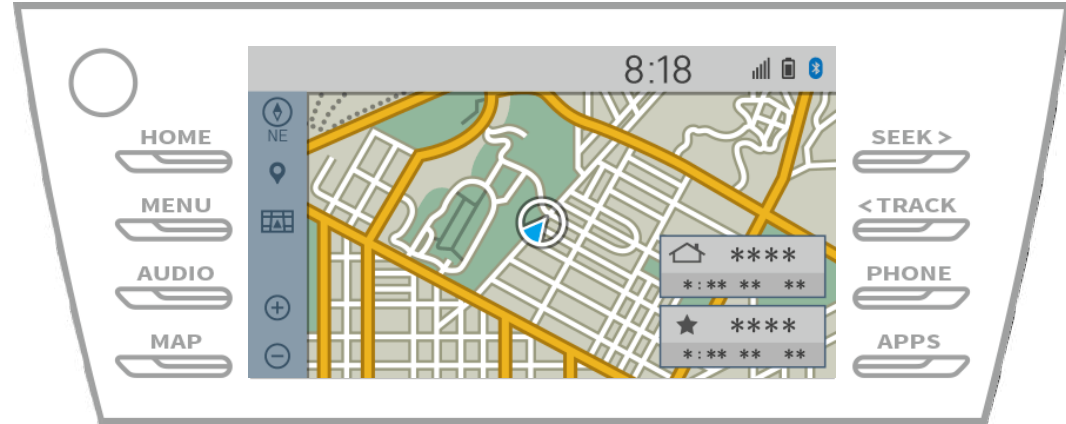
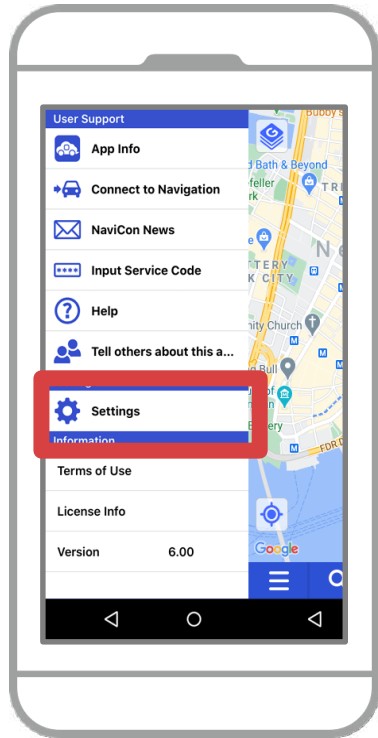

Start NaviBridge and select "Settings" from the menu on the upper left.

Smartphone

Car navigation

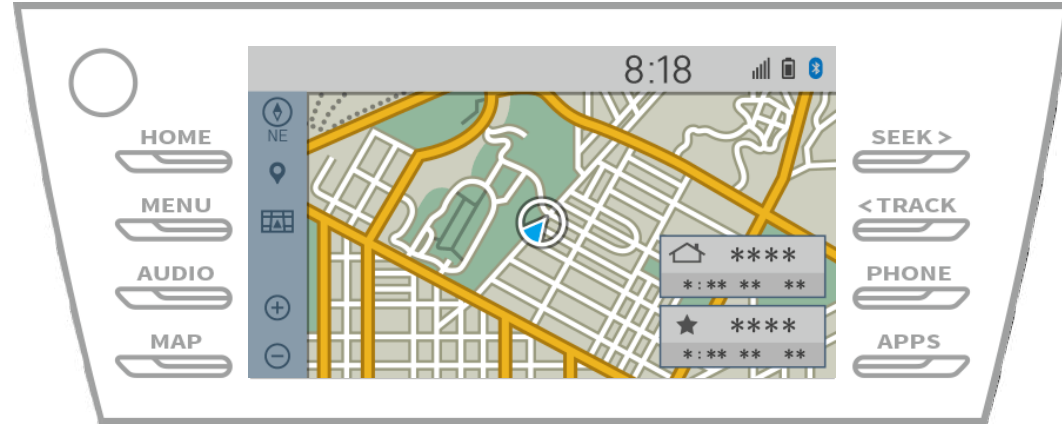
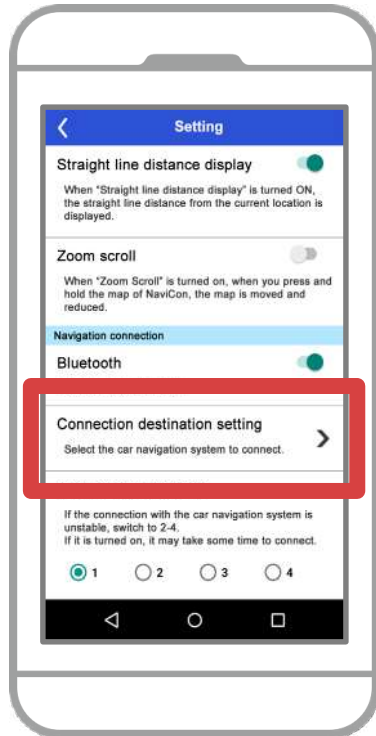

Press "Select Navigation Unit" at the bottom of the settings screen. The same screen as page 14 will be displayed, so select the car navigation system.

Smartphone

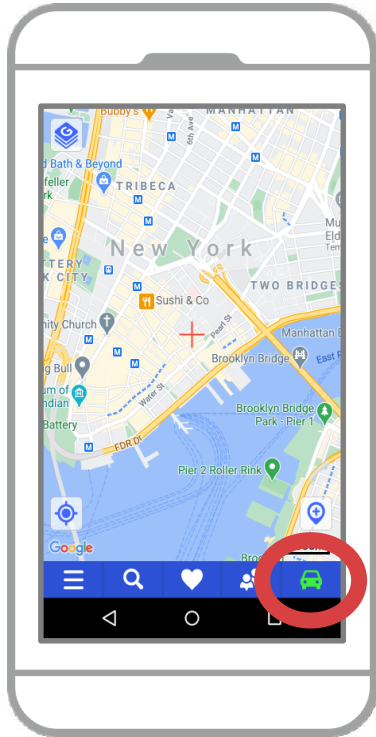

Car navigation

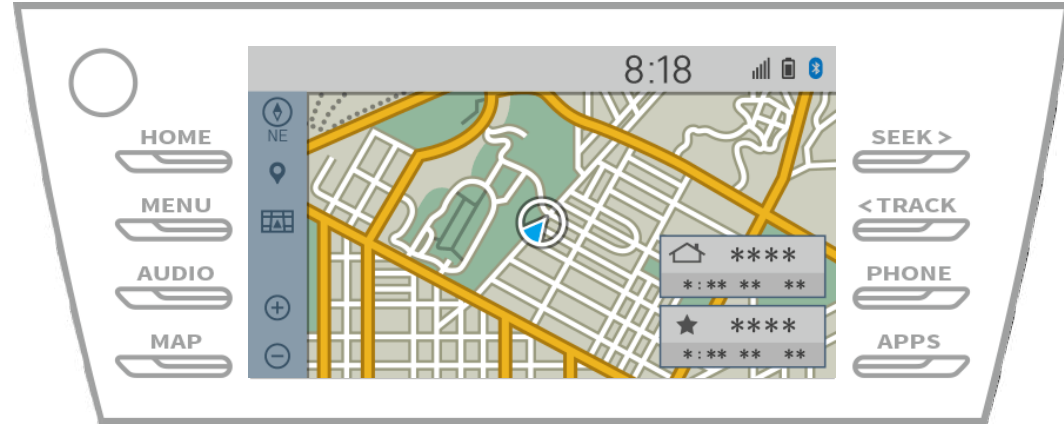

When the status display at the bottom right of the NaviBridge map screen turns ONLINE, the connection between NaviBridge and the car navigation system is complete.

If you are having trouble connecting to the car navigation system ...

- I tried pairing in the above procedure, but I couldn't connect.
- After upgrading NaviBridge, I can no longer connect.
- After updating smartphone OS, I can no longer connect.
- After changing smartphone to new one, I can no longer connect.
- When I connected the USB cable, NaviBridge turned OFFLINE.
- I don't know why, but suddenly I can't connect.



If you are having trouble connecting, we provide Q & A.

Please look at this.

<https://www.denso.com/global/en/contact-us/navibridge/>